

Front Access Assembly Instructions

1. Remove protective film on all pieces, **EXCEPT** the 2x U shaped pieces

2. Use four M3 x 6mm screws to attach 4x corner pieces to the square base, sandwich the corner standoffs underneath the acrylic, this is the base.



3. Attach one of the two larger panels using two M3 x 6mm screws

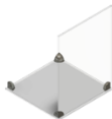

4. Attach the two smaller panels opposite each other using four M3 x 6mm screws



5. Sandwich the smaller U-shaped panel between the larger one and the front panel with the four holes at the front. Align these up and use four M3 x 16mm screws and four M3 Plain Nuts to secure it in place. Now attach this panel to complete the sides using two M3 x 6mm screws. The rectangular panel with two protruding notches is the sliding door which should slide easily into the U frame.



6. Use four M3 x 6mm screws to attach the remaining 4x grey corner pieces to the lid frame

7. Align the grey corner pieces and place the frame on the top of the enclosure so the holes match and secure in place with eight M3 x 6mm screws



8. Finally, cut the organza down to the size of the thin frame and sandwich it between the wide frame. Use four M3 x 8mm and the four M3 Nyloc Nuts to secure the organza and both the wide and thin frames should meet together. Hand tighten only.

Care Guide

In order to keep your enclosure looking its best, use de-ionised or distilled water when misting, this will prevent calcium deposits forming on the surface which obscures viewing

When cleaning, unscrew all panels and wash only with warm soapy water, do not use abrasive cleaning materials. To clean the corner connector pieces, use an old toothbrush

We also undertake custom enclosure builds, for advice or support, please get in contact:

www.promantis.uk

info@promantis.uk